



R
&
L

2 Finchley Close

Barton Green | NG11 8ST | Guide Price £185,000

ROYSTON
& LUND

- Two bedroom semi-detached
- Fitted Kitchen
- Wetroom
- Off street parking
- EPC rating D - Freehold
- Lounge
- Main bedroom with built in storage
- South facing rear garden
- Well presented throughout
- Council tax band B





A well presented two bedroom semi-detached home in Barton Green. The property benefits from off street parking, a sunny south facing garden and fantastic links into the surrounding area, city centre and M1 motorway. This would ideally suit a first time buyer or young family looking to get onto the property ladder.



Entering into the lobby, We have access into the lounge and stairs to the first floor. The lounge benefits from a fireplace and a door leading into the kitchen, which is integrated with an oven, hob, extractor and built in storage. Upstairs there is a spacious double bedroom with built in storage and a wardrobes, with a further bedroom and wet room to the rear.

Ground Floor

Approx. 28.0 sq. metres (301.6 sq. feet)

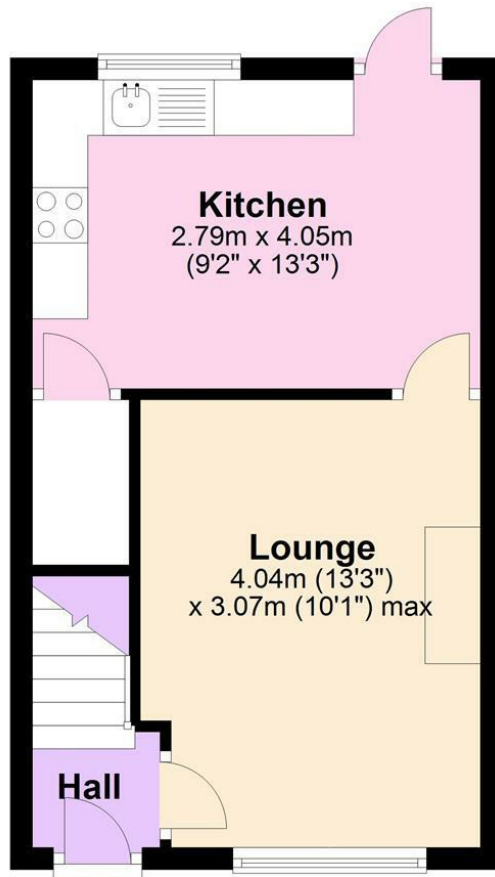

First Floor

Approx. 28.0 sq. metres (301.6 sq. feet)

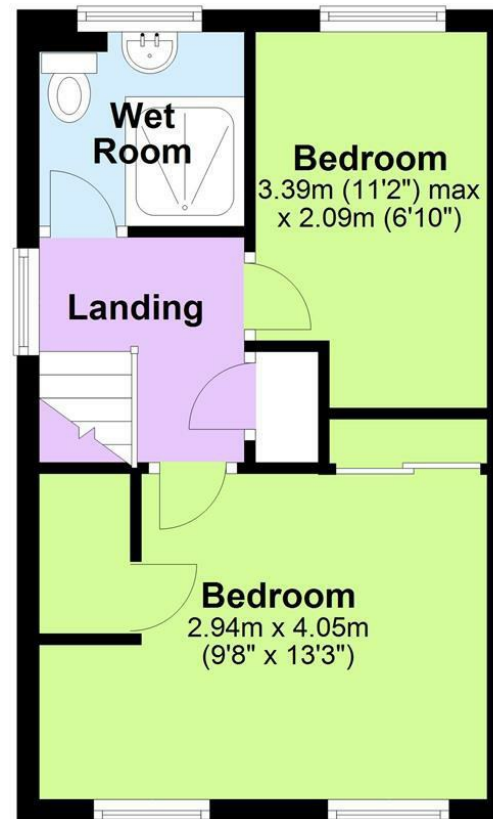

Total area: approx. 56.0 sq. metres (603.2 sq. feet)



EPC

Energy Efficiency Rating		Current	Potential
Very energy efficient - lower running costs			
(92 plus) A			85
(81-91) B			
(69-80) C		67	
(55-68) D			
(39-54) E			
(21-38) F			
(1-20) G			
Not energy efficient - higher running costs			
England & Wales		EU Directive 2002/91/EC	
Environmental Impact (CO ₂) Rating		Current	Potential
Very environmentally friendly - lower CO ₂ emissions			
(92 plus) A			
(81-91) B			
(69-80) C			
(55-68) D			
(39-54) E			
(21-38) F			
(1-20) G			
Not environmentally friendly - higher CO ₂ emissions			
England & Wales		EU Directive 2002/91/EC	

These particulars, whilst believed to be accurate are set out as a general outline only for guidance and do not constitute any part of an offer or contract. Intending purchasers should not rely on them as statements of representation of fact, but must satisfy themselves by inspection or otherwise as to their accuracy. No person in this firm's employment has the authority to make or give any representation or warranty in respect of the property.

**ROYSTON
& LUND**